



NATIONAL TERRAZZO & MOSAIC ASSOCIATION

www.ntma.com

800.323.9736

GUIDE DETAIL #E-3

Mar. 2025

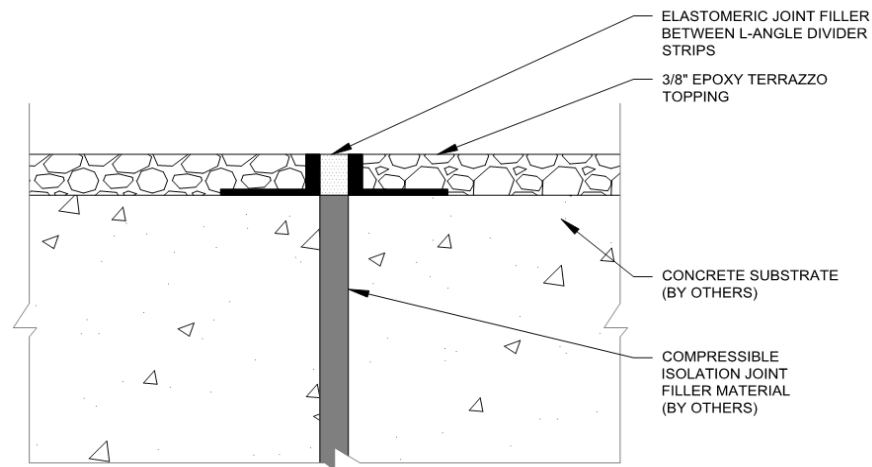

Terrazzo Detail at Concrete Isolation Joint

NOTES:

- This Terrazzo joint is designed to move in a horizontal plane and not a vertical plane.
- Concrete Isolation joints are used to separate a concrete slab from load bearing columns and walls.
- Terrazzo must honor the isolation joint in concrete slabs.
- Squares edges in concrete are encouraged for divider strip placement.

General Disclaimer: *The information provided in the Technical Bulletin is for general informational purposes only. Each project and individual application are unique. All information is provided in good faith: However, NTMA makes no representations or warranties of any kind, express or implied, regarding the accuracy, adequacy, validity, reliability, or completeness of any information provided herein.*