

Detail 2. Optional Joint Detail for Contraction Joints (Wider than 1/8")

This detail provides the designer the option of installing a low profile 16 gauge divider strip, in lieu of the filled back strip in detail 1. This detail provides limited movement compared to detail 1.

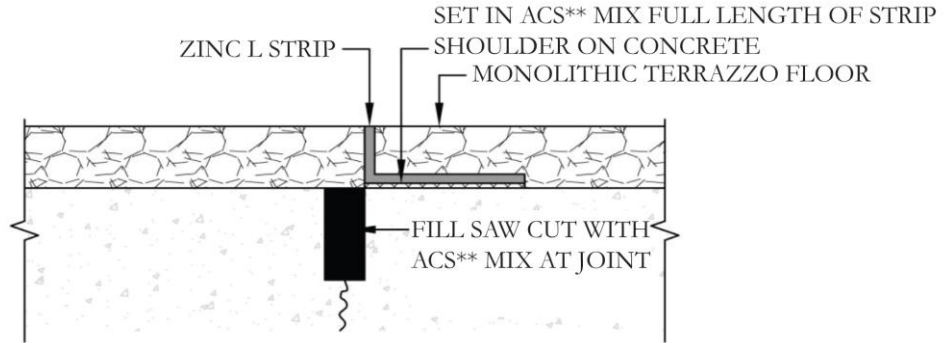

*Care should be taken by concrete contractor to provide a straight joint, placed in coordination with design teams consideration of final grid pattern. Square edges encouraged, tooled edges discouraged.

**ACS stands for Acrylic Cement Sand